



Construction

Cafco Silverflame Fire Batt

Data Sheet C/FS/P-1

Use with:

Cafco Silverflame Trowel & Spray Grade Sealant

See Data Sheet C/FS/P-3

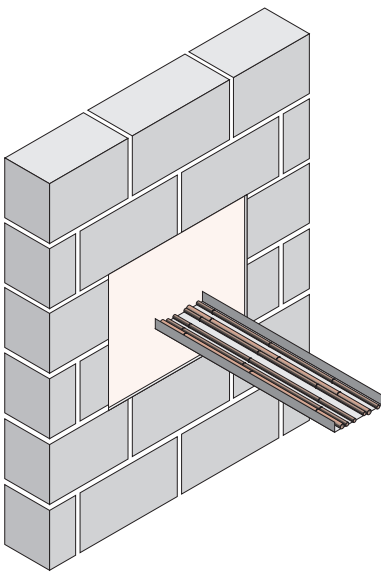

Cafco Silverflame Fire Batt used as a fire barrier in a compartment wall

Cafco Silverflame Fire Batts are boards of dense mineral wool coated with Cafco ablative mastic on both sides.

The batts and sealant are designed to prevent the passage of fire and smoke through a compartment wall or floor, whilst allowing the easy installation of services.

At normal temperatures, the batt remains flexible enough to allow for the thermal and mechanical movement of services.

Batts are used with a cartridge/pail of **Cafco Silverflame Trowel & Spray Grade Sealant** for application to cut edges.

Its advantages are:

- Fire and smoke barrier up to 240 minutes to BS 476: Parts 20 & 22
- Remains flexible between -5°C to +70°C
- Suitable for large openings with additional support
- Ease of installation and long life
- Acoustic isolation.

Properties and performance

Mineral fibre board

T960D 900 x 600 x 60mm.
T1200D 1200 x 600 x 60mm.

Density

160kg/m³.

Coating thickness

T960D and T1200D
2mm nominal wet film thickness.

Fire resistance

T960D and T1200D
240 minutes to BS 476: Parts 20 and 22.

Low resin content

2%.

Heat ageing – 336 hours

No defects at 40°C.

Water vapour permeability

3.08gm/m²/24 hours ASTM D1653.

Artificial weathering – 1000 hours

No defects to BS 3900: F3.

Acoustic performance

T960D and T1200D
34.7dB at 100Hz to 59.5dB at 5000Hz.

Maximum size of seal

T960D and T1200D
Wall: 5.76m². Floor: 2.88m².

Properties and performance (cont)

Maximum size unsupported

1200 x 600mm.

Mechanical support required

30 x 30 x 1.6mm steel angle.

Cafco S'flame T/S Grade Sealant coverage

2.37kg/m² trowelled. 2.50kg/m² spray.

Installation

General considerations

Installation details and technical support are available from Cafco Fire Seals Technical Department.

- Use rubber gloves and protection to avoid skin and eye contact.
- Cut board and profile to suit the opening and services.
- Apply **Cafco Silverflame Trowel & Spray Grade Sealant** to cut surfaces and mating substrate.
- Friction fit board into opening.
- Apply mastic from cartridge/pail to seal any visible openings.
- Maintain a record of installation.

Packaging, storage, shelf life

Packaging

Supplied singly within a heavy duty polythene bag.

Storage

Indoors in dry conditions, within temperature range -5°C to +30°C.

Shelf life

No limit.

Environmental

Not readily biodegradable.

Not expected to bioaccumulate.

Not expected to be toxic to aquatic life except at high concentrations.

Do not discharge into drains and watercourses.

Health and safety

Cafco International's activities are conducted with due regard to all statutory requirements with appropriate safeguards against exposing employees and the public to health and safety risks.

A full copy of Cafco International's Health, Safety and Environment Policy document is available on request.

See Safety Data Sheet (including COSHH Regulations) Code Reference **Saf-25**.

Quality assurance

Cafco International operates a quality system in accordance with BS EN ISO 9002: 1994, and has received full accreditation by BSI to these standards.

Operating to these standards means that all activities, which have a bearing upon quality, are set out in written procedures. Systematic and thorough checks are made on all materials and their usage. Test equipment is subjected to regular checks and is referred back to national standards.

The information given in this data sheet is based on actual tests and is believed to be typical of the product. No guarantee of results is implied however, since conditions of use are beyond our control.

Further information



**Bluebell Close
Clover Nook Industrial Park
Alfreton
Derbyshire
DE55 4RA
UK**

Tel: +44 (0) 1773 837 900
Fax: +44 (0) 1773 836 710
Email: info@cafcointl.com
Website: www.cafcointl.com

**3 Rue de L'Industrie
L-3895 Foetz
G. D. of Luxembourg**

Tel: 00 352 55 17 17
Fax: 00 352 55 27 99